

# pipetman®

L

## Precision, Comfort, and Reliability Engineered for Everyday Lab Performance

PIPETMAN® L is designed to reduce hand fatigue and increase productivity. Its lightweight, perfectly balanced design and low pipetting forces help you stay focused, even during long pipetting sessions.

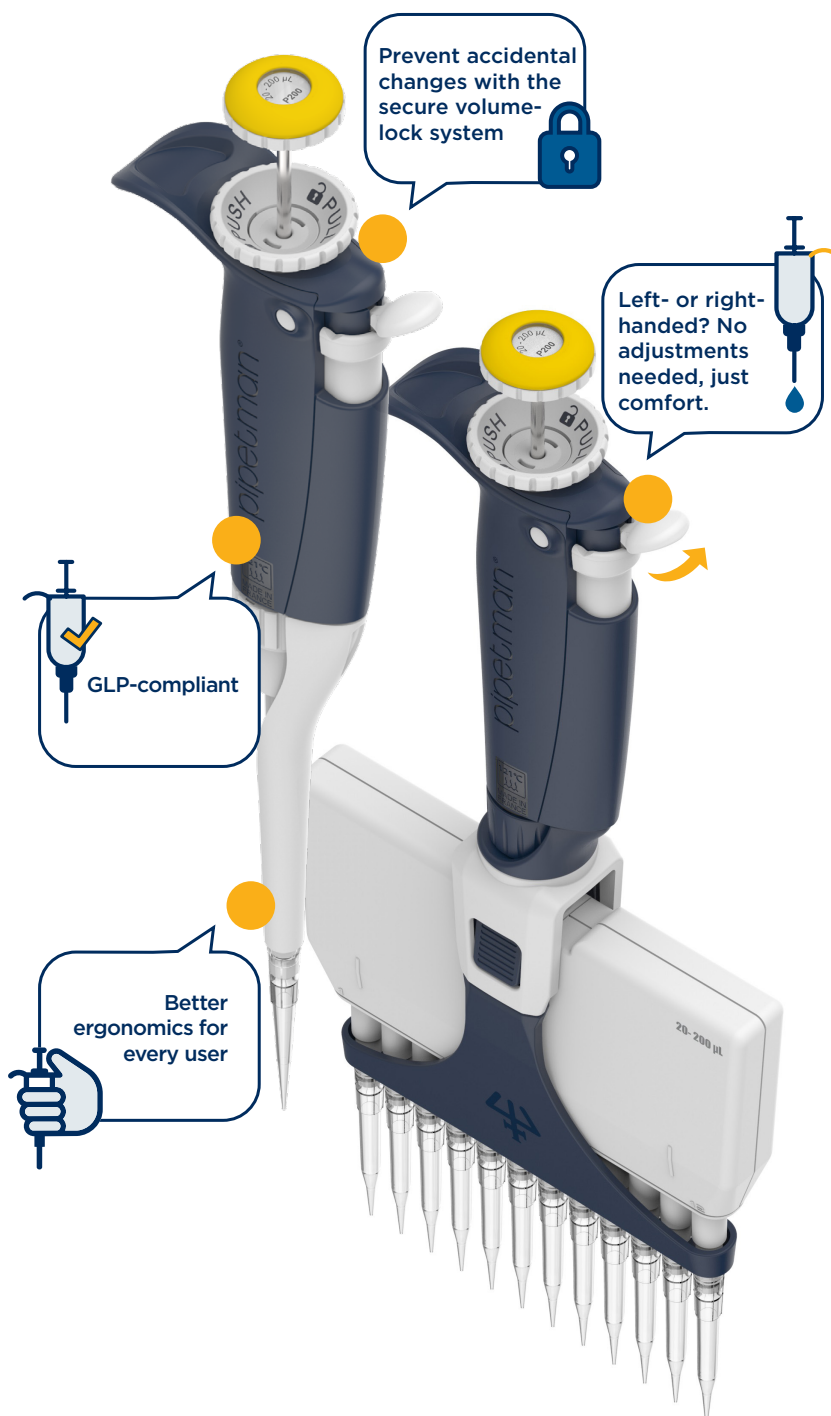

### Work Longer Without Fatigue

- Reduced risk for RSIs
- More consistent results over time
- Higher daily throughput

### Confidence in Every Pipetting Step

- Reliable, reproducible results you can trust
- Secure volume locking to prevent accidental changes
- Confidence when it matters most in critical experiments
- Fully autoclavable for better protection against cross-contamination

### The Right Solution for Every Task

- Broad volume range: 0.2  $\mu$ L to 10 mL in single channel models
- Multichannel options up to 1200  $\mu$ L for flexible protocol support
- Fixed-volume models for consistent, repeatable tasks
- Multichannel V-ring design on select models enhances tip fit across most brands



An ideal solution for Biotechs, clinical labs, and high-intensity routine environments

 **GILSON®**

| PIPETMAN L Single Channel — Variable Volume Models |                        |                      |             |              |
|--|------------------------|----------------------|-------------|--------------|
| Model  | PIPETMAN® DIAMOND Tips |                      | Part Number | Volume (µL)  |
| P2L  | D10<br>DL10            | DF10ST<br>DFL10ST    | FA10001P    | 0.2 - 2      |
|  |                        |                      | FA10001M    |              |
| P10L   | D10<br>DL10            | DF10ST<br>DFL10T     | FA10002P    | 0.5 - 10     |
|  |                        |                      | FA10002M    |              |
| P20L   | D200                   | DF30ST               | FA10003P    | 2 - 20       |
|  |                        |                      | FA10003M    |              |
| P100L  | D200                   | DF100ST              | FA10004P    | 10 - 100     |
|  |                        |                      | FA10004M    |              |
| P200L  | D200<br>D300           | DF200ST<br>DF300ST   | FA10005P    | 20 - 200     |
|  |                        |                      | FA10005M    |              |
| P1000L   | D1000<br>D1200         | DF1000ST<br>DF1200ST | FA10006P    | 100 - 1000   |
|  |                        |                      | FA10006M    |              |
| P5000L   | D5000                  |                      | FA10007     | 500 - 5000   |
| P10mLL   | D10mL                  |                      | FA10008     | 1000 - 10000 |



**SCAN ME!**

Ready to upgrade your pipetting experience?

\*For a pipette with a plastic tip ejector, the part number ends with the letter P. For a pipette with a stainless steel tip ejector, the part number ends with the letter M, from P2L to P1000L.

| PIPETMAN L Multichannel Models |                        |                    |             |             |
|--------------------------------|------------------------|--------------------|-------------|-------------|
| Model                          | PIPETMAN® DIAMOND Tips |                    | Part Number | Volume (µL) |
| P8x10L                         | D10<br>DL10            | DF10ST<br>DFL10ST  | FA10013     | 0.5 - 10    |
| P12x10L                        |                        |                    | FA10014     |             |
| P8x20L                         | DL10<br>D200           | DFL10ST<br>DF30ST  | FA10009     | 2 - 20      |
| P12x20L                        |                        |                    | FA10010     |             |
| P8x200L                        | D200<br>D300           | DF200ST<br>DF300ST | FA10011     | 20 - 200    |
| P12x200L                       |                        |                    | FA10012     |             |
| P8x200LVR**                    | D200<br>D300           | DF200ST<br>DF300ST | FA10035     | 20 - 200    |
| P12x200LVR**                   |                        |                    | FA10036     |             |
| P8x300L                        | D200<br>D300           | DF200ST<br>DF300ST | FA10015     | 20 - 300    |
| P12x300L                       |                        |                    | FA10016     |             |
| P8x300LVR**                    | D200<br>D300           | DF200ST<br>DF300ST | FA10037     | 20 - 300    |
| P12x300LVR**                   |                        |                    | FA10038     |             |
| P8x1200L                       | D1200                  | DF1200ST           | FA10039     | 100 - 1200  |
| P12x1200L                      |                        |                    | FA10040     |             |



\*\*Models equipped with V-rings.

| PIPETMAN® L KITS            |             |                                |                        |   |
|-----------------------------|-------------|--------------------------------|------------------------|---|
| Model                       | Part Number | PIPETMAN L Models              | PIPETMAN® DIAMOND Tips | Accessories                                     |
| PIPETMAN L Starter Kit      | F167350     | P20L<br>P200L<br>P1000L        | D200<br>D1000          | 3 SINGLE™ pipette holders<br>3 plastic ejectors |
| PIPETMAN L Micro-volume Kit | F167550     | P2L<br>P10L<br>P100L           | DL10<br>D200           | 3 SINGLE™ pipette holders<br>3 plastic ejectors |
| PIPETMAN L 4-Pipette Kit    | F167370     | P2L<br>P20L<br>P200L<br>P1000L | DL10<br>D200<br>D1000  | 4 SINGLE™ pipette holders<br>4 Plastic ejectors |

## Choose your Tip Ejector

For single channel models, choose between a model with a stainless-steel tip ejector or a plastic ejector\* depending on your needs and applications.

Large volume models are equipped with a plastic tip ejector to avoid any direct contact with the tip.

## Choose Your Model

For routine testing applications, PIPETMAN L is available in fixed-volume models\*\*\* from 1 µL to 5 mL, helping reduce the risk of volume errors and ensure consistent results. With the same lightweight, ergonomic design, it's a reliable choice even for non-trained lab technicians.

\*\*\*PIPETMAN L Fixed models are not fully autoclavable.

PIPETMAN L single channel models are available in kits, offering the essential pipetting tools to start an experiment right away.



PIPETMAN DIAMOND® Tips are designed to fit your PIPETMAN perfectly and guarantee maximum accuracy and precision.

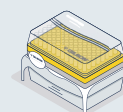

For ordering information, visit [www.gilson.com](http://www.gilson.com)

[gilson.com/contactus](http://gilson.com/contactus)

LT800606/C | ©2026 Gilson S.A.S.  
All rights reserved. All trademarks are the property of Gilson, Inc. and its subsidiaries.

**GILSON®**